

## 简体中文

### 母乳储存袋说明书

货号: MB08



操作视频服务到  
手机扫一扫

### 简介

中亲母乳储存袋可为您提供安全和方便的方式来收集宝贵的母乳。其采用双层结构、加固的塑料并具有较强的密封, 确保在存储过程中保护母乳。坚固的宽口可确保安全、轻松地注入和倒出母乳。为了保证卫生, 每个储存袋均经过预先消毒, 带有防撕密封。

### 注意事项

使用母乳储存袋之前, 请仔细阅读本用户手册, 并妥善保管以备日后参考。

### 警告

- 将母乳储存袋放在儿童接触不到的地方。
- 哺喂宝宝前务必检查母乳的温度。
- 为防止母乳过热, 请不要将装有母乳的母乳储存袋放在微波炉、刚烧开的水中或奶瓶加热器中解冻。

### 注意

- 母乳储存袋仅限于一次使用。
- 注入母乳及倒空母乳储存袋之前要彻底洗净双手。
- 母乳储存袋实际容纳乳汁量可能会与袋上

所标记稍有不同。

- 切勿再次冷冻母乳或在已冷冻过的母乳内添加新鲜的母乳。
- 母乳可以再冰箱中最长存放 48 小时 (非冰箱门附近), 在冷冻室中最长可以存放 3 个月。

### 解冻母乳

要在前一天晚上解冻母乳, 请将母乳储存袋存放在冰箱中。

要在哺喂前解冻, 请将母乳储存袋放在温水中。

### 温度标示



Cold

蓝色和红色均显示  
表示此时温度过凉



Hot

蓝色和红色均不显示  
表示此时温度过热



Good

蓝色不显示, 红色显示  
表示此时温度适宜

### 向母乳储存袋中注入乳汁

- ① 撕掉顶部的防撕密封, 打开母乳储存袋。将撕下的密封放在儿童接触不到的地方, 并以安全的方式进行处理。(图 1)
- ② 要打开储存袋, 请将拇指放入拉链上方的塑料袋内, 轻轻将两侧拉开。(图 2)
- ③ 将挤出的母乳倒入储存袋。注入量切勿超过 200ml。冷冻后母乳会膨胀。(图 3)
- ④ 将母乳上方的储存袋部分小心的捏平以去除多余的空气。拉上拉链, 密封储存袋。(图 4)
- ⑤ 用笔在标签写下吸乳的日期及其他信息。切勿在装有母乳的部位写字。以防刺破储存袋。(图 5)

### 从母乳储存袋中倒出母乳

- ① 倒出母乳时, 撕掉标签区以消除潜在的母乳污染。(图 6)
  - ② 要打开储存袋, 请将拇指放在拉链上方的塑料内, 将两侧拉开。(图 7)
  - ③ 握住储存袋拉链, 将母乳倒入容器中。(图 8)
- 提示: 轻轻地挤压拉链, 使倾倒更容易。
- ④ 使用后扔掉母乳储存袋。请勿重新使用母乳储存袋。
  - ⑤ 要加热母乳, 请将装有已解冻的母乳的容器放入奶瓶加热器或一碗热水中。
- 注意: 务必丢弃哺喂后剩余的母乳。

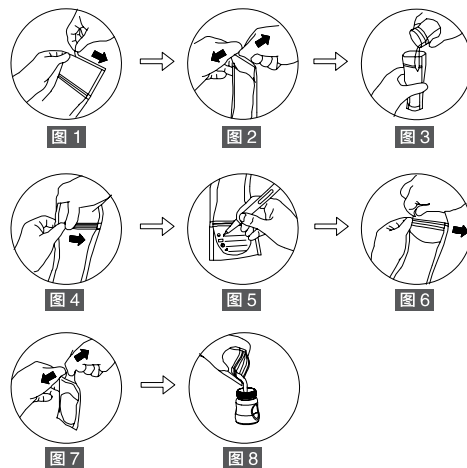

## ENGLISH

Breast milk storage bags specification      Product code:MB08

### Introduction

The CCHMBB milk storage bags offer a safe and convenient way to collect your precious breast milk. They are made of dual-layer, reinforced plastic and have a strong seal, to ensure your milk remains protected while being stored. A wide and sturdy opening ensure safe and easy filling and pouring. For ultimate hygiene, every bag comes presterilised with a tamper-evident seal.

### Important

Read this user manual carefully before you use the milk storage bags and save it for future reference.

### Warning

- Keep the milk storage bags out of the reach of children.
- Always check the temperature of the milk before you feed your baby.
- To prevent the milk from overheating, do not defrost the milk storage bag with breast milk in the microwave, in freshly boiled or in a bottle warmer.

### Caution

- The milk storage bags are intended for onetime use only.
- Thoroughly wash your hands before you fill and empty the milk storage bags.
- The actual amount of milk in the bag may deviate

slightly from the level indications on the bag.

- Never refreeze breast milk or add fresh breast milk to already frozen breast milk.
- You can store the milk storage bag in the refrigerator for up to 48 hours(not in the door) or in the freezer for up to 3 months

### Defrosting breast milk

To defrost breast milk overnight, place the milk storage bag in the refrigerator.

To defrost breast milk prior to feeding, place the milk storage bag in warm water.

### Temperature labeling



**Cold**  
blue and red display,  
the temperature is  
too low



**Hot**  
blue and red not  
display,the temperature  
is too high



**Good**  
blue display, red  
not display, the  
temperature is well

### Filling the milk storage bag

- ① Open the milk storage bag by tearing off the tamper-evident seal at the top of milk storage bag. Keep the torn-off seal away from children and dispose of it safely (Fig.1)
- ② To open the bag, place your thumbs inside the plastic above the zip and gently pull both sides apart (Fig.2)
- ③ Pour the expressed milk into the bag. Do not fill the bag beyond the 200ml, as breast milk expands when frozen (Fig.3)
- ④ Carefully remove excess air by flattening the part of the bag above the milk. Seal the bag by closing the zip (Fig.4)
- ⑤ Use a pen to write down the date of expression and other information on the labelling area. Do not write on the filling part to prevent puncturing the bag (Fig.5)

### Pouring milk from the milk storage bag

- ① Tear off the labelling area to eliminate potential contamination of the breast milk during pouring (Fig.6)
- ② To open the bag, place your thumbs inside the plastic above the zip and pull both sides apart (Fig.7)
- ③ Hold the bag by the zip and pour the milk into a container (Fig.8)  
Tip: Lightly squeeze the zip to make pouring easier.
- ④ Throw away the milk storage bag after use. Do not reuse the milk storage bag.
- ⑤ To heat the milk, place the container with defrosted milk in a bottle warmer or in a bowl of hot water.

Note: Always discard any breast milk that is left over at the end of a feed.

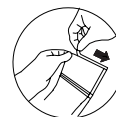

Fig.1



Fig.2



Fig.3



Fig.4



Fig.5



Fig.6



Fig.7

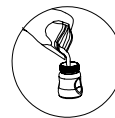

Fig.8